

# UNIVERSITY OF UTAH WILLIAMS BUILDING NEW AUDIOVISUAL SYSTEMS ROOMS 223, 238, BOARDROOM

---



MARSHALL INDUSTRIES  
3800 WEST 2100 SOUTH  
SALT LAKE CITY, UT 84120  
801-266-2428

January 13, 2017



Turns Power On (Green) or Off (White) to the Projector. After you turn Power Off, you must wait a minute for the Projector fan to turn off before you can turn it back on again.

Turns Power On (Green) or Off (White) to the TV Display

Selects either the East table (closest to the door) or West table (closest to the screen) inputs in the table boxes. The HDMI and VGA inputs autoswitch, depending on which one is active. The AV inputs for the Projector and Wall Display can be the same or different. The last input selected controls the source of the audio over the speakers.

Selects the Polycom videoconference unit on the table, to use for Skype calls.

Selects the source to be shown on the Video Projector.

Selects the source to be shown on the TV Display on the east wall.

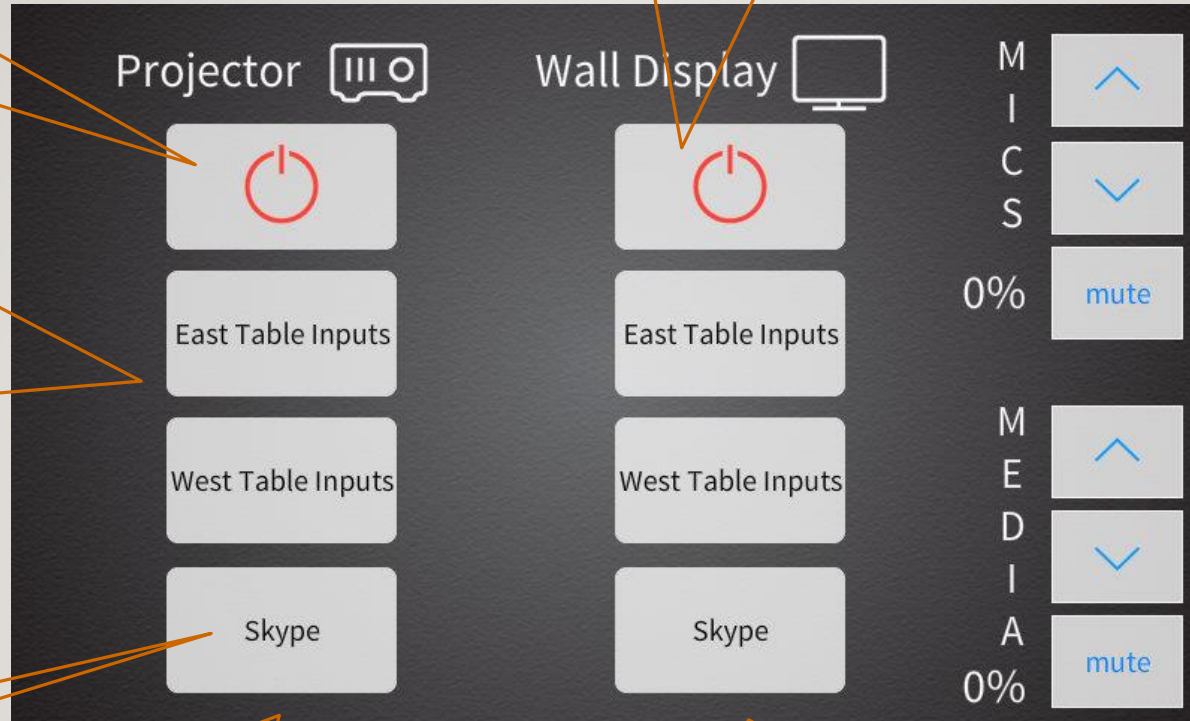

Controls Volume and Mute of the Wireless Mics in this room.

Controls Volume and Mute of the all presentation audio sources (laptops, Skype, etc).

**BOARDROOM**

NOTE: Each half of the divisible room can be controlled either by the touch panel in the wall, or the touch panel sitting on the podium. The two panels within each half of the room mirror each other.

Turns Power On (Green) or Off (White) to the Projector. After you turn Power Off, you must wait a minute for the Projector fan to turn off before you can turn it back on again.

Selects the inputs in the floor boxes either closest to the Projector (front wall), or closest to the TV Wall Display (side wall). The HDMI and VGA inputs autoswitch, depending on which one is active. The AV inputs for the Projector and Wall Display can be the same or different. The last input selected controls the source of the audio over the speakers.

Turns Power On (Green) or Off (White) to the TV Wall Display

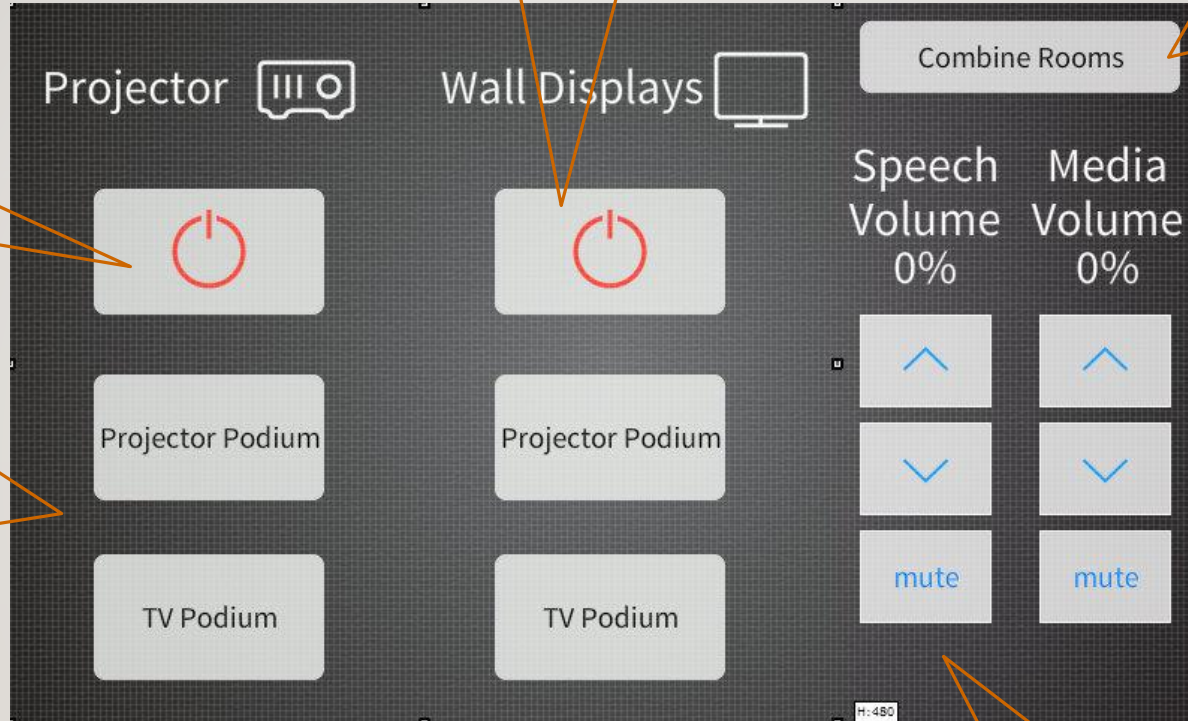

Selects whether the two halves of the room are Combined (Blue) or Not combined (White). When combined, any of the 223 A or B microphones will play in both rooms. Video from 223A will automatically show on the Wall Display in 223B if it is turned on, but not on the 223B projector. When the rooms are then uncombined, the 223B wall display will go blank until you make a selection on the 223B wall control.

Controls Volume and Mute of the all presentation audio sources (laptops, DVDs, etc).

Selects the source to be shown on the Video Projector.

Selects the source to be shown on the TV Display.

Controls Volume and Mute of the hardwired and Wireless Mics in this room.

## ROOM 223 A, 223B

NOTE: This half of the divisible room can be controlled either by the touch panel in the wall, or the touch panel sitting on the podium. The two panels in this half of the room mirror each other.

Turns Power On (Green) or Off (White) to the Projector. After you turn Power Off, you must wait a minute for the Projector fan to turn off before you can turn it back on again.

Selects the inputs in the floor boxes either closest to the Projector (front wall) or closest to the TV Wall Display (west wall), or the input plate on the east wall. The HDMI and VGA inputs autoswitch, depending on which one is active. The AV inputs for the Projector and Wall Displays can be the same or different. The last input selected controls the source of the audio over the speakers.

Turns Power On (Green) or Off (White) to both TV Wall Displays

Selects whether the two halves of the room are Combined (Blue) or Not combined (White). When combined, any of the 238 A or B microphones will play in both rooms. Video from 238A will automatically show on the Wall Display in 238B if it is turned on, but not on the 238B projector. When the rooms are then uncombined, the 238B wall display will go blank until you make a selection on the 238B wall control.

Controls Volume and Mute of the all presentation audio sources (laptops, DVDs, etc).

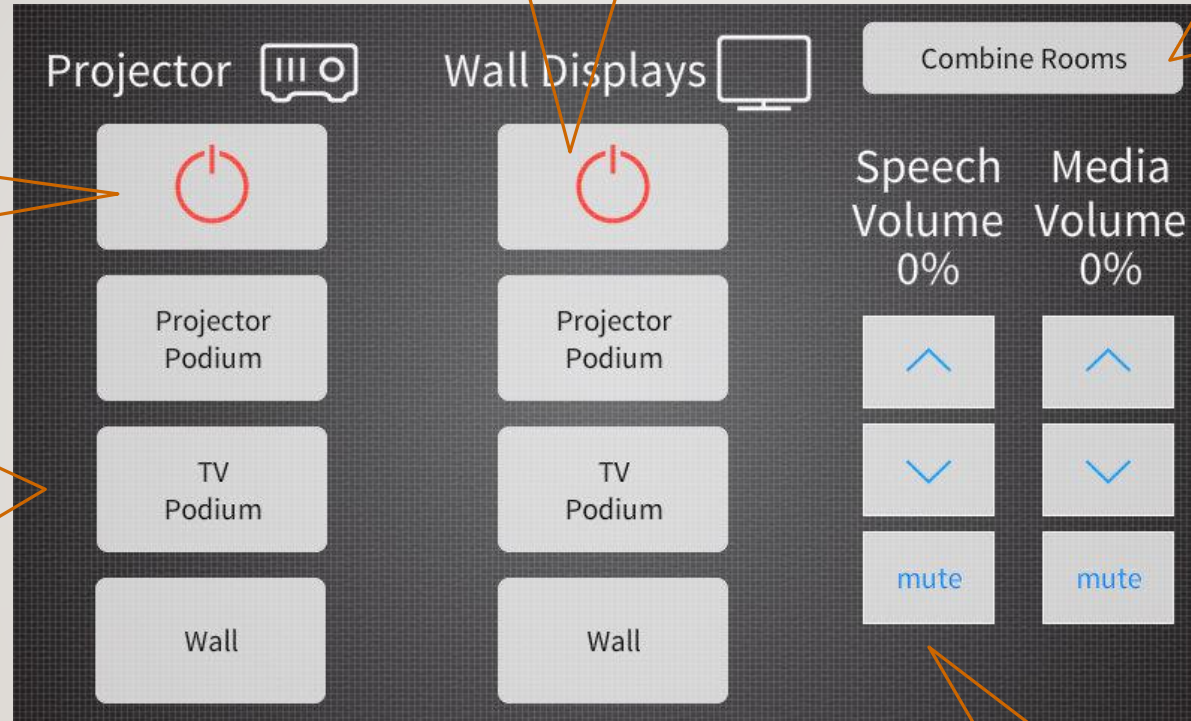

Selects the source to be shown on the Video Projector.

Selects the source to be shown on both TV Wall Displays.

Controls Volume and Mute of the hardwired and Wireless Mics in this room.

ROOM 238 A

Turns Power On (Green) or Off (White) to the Projector. After you turn Power Off, you must wait a minute for the Projector fan to turn off before you can turn it back on again.

Selects the inputs in the floor box under the Podium, or the input cables in the Table. The HDMI and VGA inputs autoswitch, depending on which one is active. The AV inputs for the Projector and Wall Display can be the same or different. The last input selected controls the source of the audio over the speakers.

Selects the Polycom videoconference unit on the table, to use for Skype calls.

Turns Power On (Green) or Off (White) to the TV Wall Display

Selects whether the two halves of the room are Combined (Blue) or Not combined (White). When combined, any of the 223 A or B microphones will play in both rooms. Video from 223A will automatically show on the Wall Display in 223B if it is turned on, but not on the 223B projector. When the rooms are then uncombined, the 223B wall display will go blank until you make a selection on the 223B wall control.

Controls Volume and Mute of the all presentation audio sources (laptops, Skype, etc).

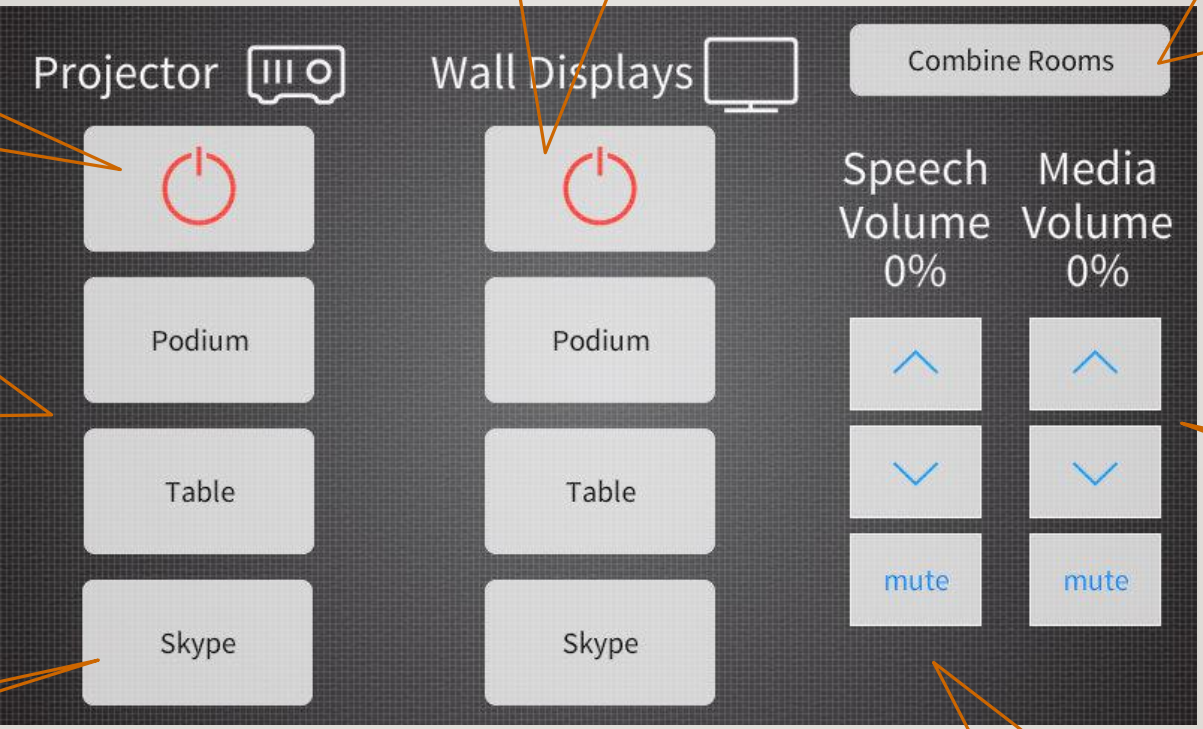

Selects the source to be shown on the Video Projector.

Selects the source to be shown on the TV Display.

Controls Volume and Mute of the hardwired and Wireless Mics in this room.

# ROOM 238B